

3" ARCHITECTURAL SQUARE DOWNLIGHT COMPATIBLE WITH ARMSTRONG® WOODWORKS®  
LINEAR SOLID WOOD PANELS 3¼" WIDE PLANKS



### USE OF PRODUCT

The 3" Prime series is a small aperture fixture which is compatible with Armstrong® WoodWorks® linear solid wood panels 3¼" wide planks. Available options include die-cast trims, various temperatures, optics, and dimmable drivers.

### LED ENGINE

LED engine available with CREE LEDs in 2700K, 3000K, 3500K, or 4000K in standard 90+ CRI. 2-step MacAdam ellipse allows for color consistency between fixtures. The LED is mounted to an aluminum heat sink for maximum life output and thermal management. LED engine is accessible from below the ceiling.

### FRAME CONSTRUCTION

Non IC housing is constructed from 20-gauge cold-rolled steel and includes a junction box with ½" knockouts. Custom expandable mounting bars mount directly to ceiling grid.

### OPTICAL LENS

Field replaceable optical lenses are available in 12°, 25°, 30°, 40°, 50°, and 70°. Easily achieve narrow spot to wide flood beam pattern.

### DIMMING

Available in nine driver selections. (ID) Standard all-inclusive ELV (120V), Triac (120V), and 0–10V (120–277V) dimming driver called Intelligent Drive, (EEL) eldoLED 1% Dim 0-10V, (EES) eldoLED 1% Dim 0-10V (120-277V) and Triac (120V), Max 20W, (EDIO) eldoLED 0.1 Dim 0-10V, (EDID) eldoLED 0.1% Dim DALI, (EDD) eldoLED 1% Dim DALI2, (LDE1) Lutron Hi-Lume 1% Ecosystem with Soft-on, Fade-to-Black Dimming, (L3DA) Hi-Lume 1% Ecosystem/3-Wire L3D Driver, (PEQ0) Lutron Hi-Lume Premier Ecosystem 0.1% with Soft-on, Fade-to-Black Dimming.

### THERMAL MANAGEMENT

Fixture location ambient temperature should not exceed -20° to 40°C.

### BEVEL

Bevel includes standard frosted acrylic diffuser. Remove standard frosted acrylic diffuser in field for 7% lumens increase. Consult factory for made-to-order finishes. Wet location for bathrooms and showers with standard lens on trim.

### EMERGENCY BATTERY

Optional 8W (≈800 lm) or 15W (≈1,500 lm) emergency battery (EM) provides light for a minimum of 90 minutes. EM is replaceable from below the ceiling.

### LABELS/COMPLIANCE/WARRANTY

- CSA Listed for US and Canada.
- Energy Star certified product.
- Dry/Damp location rated.
- 5-year limited warranty.

## GENERAL PERFORMANCE CHART

\*Detailed performance chart may be found on page 3

	6W	9W	12W	15W	20W
<b>Initial Lumens</b>	657/955	890/1296	1122/1618	1267/2015	1485/2422
<b>Delivered Lumens</b>	586-755	794-1038	999-1319	1060-1642	1244-1985

\* Values are listed at 3000K, 90+ CRI with a white bevel & trim.  
Delivered lumens range based on beam spread.  
Performance may vary +/- 5%

## BEAM SPREAD

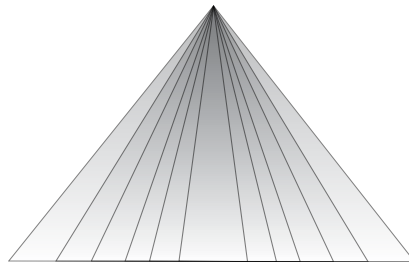

Available optics: 12° 25° 30° 40° 50° 70°

- Field replaceable TIR optics
- Easily achieve narrow spot to wide flood beam pattern
- Optional filters available upon request

## PRIME FAMILY OF PRODUCTS



Downlight      TechZone®      WoodWorks®      Multiple Dedicated Bevel      Multiple Open Bevel      Cylinder      Square Luminaire

## 3" ARCHITECTURAL SQUARE DOWNLIGHT COMPATIBLE WITH ARMSTRONG® WOODWORKS® LINEAR SOLID WOOD PANELS 3¼" WIDE PLANKS

### ORDERING INFORMATION

Series	Wattage	Dimming	Color Temperature	Optical Lens	Filter
RPA3	<b>6W</b> - 6 Watt <b>9W</b> - 9 Watt <b>12W</b> - 12 Watt <b>15W</b> - 15 Watt <b>20W</b> - 20 Watt <b>24W</b> - 24 Watt <b>28W</b> - 28 Watt <b>32W</b> - 32 Watt	<b>ID<sup>1</sup></b> - Standard All-Inclusive ELV, Triac, and 0-10V Dimming Driver (Intelligent Drive) <b>EEI<sup>2</sup></b> - eldoLED 1% Dim (0-10V) <b>EEIS<sup>3</sup></b> - eldoLED 1% Dim 0-10V (120-277V), Triac (120V), Max 20W <b>EDIO<sup>2</sup></b> - eldoLED 0.1% Dim (0-10V) <b>EDID<sup>2</sup></b> - eldoLED 0.1% Dim (DALI) <b>EDD<sup>2</sup></b> - eldoLED 1% Dim (DALI2) <b>LDE1<sup>4</sup></b> - Lutron Hi-Lume 1% Ecosystem with Soft-on, Fade-to-Black Dimming <b>L3DA<sup>4</sup></b> - Hi-Lume 1% Ecosystem/3-Wire L3D Driver <b>PEQ0</b> - Lutron Hi-Lume Premier Ecosystem 0.1% with Soft-on, Fade-to-Black Dimming	<b>27</b> - 2700K <b>30</b> - 3000K <b>35</b> - 3500K <b>40</b> - 4000K	<b>12<sup>5</sup></b> - 12° <b>25</b> - 25° <b>30</b> - 30° <b>40</b> - 40° <b>50</b> - 50° <b>70</b> - 70°	<b>None</b> - Leave Blank <b>F</b> - Frosted Filter <b>H</b> - Honey Comb <b>S</b> - Solite Filter <b>L</b> - Linear Filter

Housing Type	Collar	Woodworks Collar Finish	Module Type	Frame Accessories
<b>WW8177</b> - Woodwork No. 8177	<b>CS15</b> - 1.5" Depth <b>MTO</b> - Made To Order	<b>B<sup>6</sup></b> - Black <b>BZ</b> - Bronze <b>MTO</b> - Made To Order	<b>FMH</b> - Downlight	<b>UH</b> - Universal Bar Hanger

Options	Wireless Controls	Notes
<b>ER8W</b> - Emergency Battery with Remote test switch (800 lm) <b>ER15W</b> - Emergency Battery with Remote test switch (1,500 lm)	<b>AWN</b> - Athena Wireless (Lutron) <b>CLM</b> - Connected Lighting Module (Legrand Wattstopper)	<ol style="list-style-type: none"> <li>Intelligent Drive is the standard driver.</li> <li>Must specify logarithmic or linear eldoLED driver.</li> <li>Driver available up to 20W and programmed only in linear mode.</li> <li>Not offered in 6W.</li> <li>12° spread without lens on trim.</li> <li>Black is the standard color.</li> </ol>

### TRIM ORDERING INFORMATION

#### DIE-CAST

Bevel Finish	Bevel	Finish
<b>3" Square Flangeless Regress Small Opening</b>	3SLO-CS	<b>W</b> - White
	3SLO-CS	<b>B</b> - Black
	3SLO-CS	<b>H</b> - Haze
	3SLO-CS	<b>BZ</b> - Bronze
	3SLO-CS	<b>C</b> - Clear
	3SLO-CS	<b>MTO</b> - Made To Order
<b>3" Square Flangeless Regress Large Opening</b>	3SLO-CL	<b>W</b> - White
	3SLO-CL	<b>B</b> - Black
	3SLO-CL	<b>H</b> - Haze
	3SLO-CL	<b>BZ</b> - Bronze
	3SLO-CL	<b>C</b> - Clear
	3SLO-CL	<b>MTO</b> - Made To Order

3" ARCHITECTURAL SQUARE DOWNLIGHT COMPATIBLE WITH ARMSTRONG® WOODWORKS®  
 LINEAR SOLID WOOD PANELS 3¼" WIDE PLANKS

## PERFORMANCE CHART

Optics		<sup>1</sup> 12°	25°	30°	40°	50°	70°
<b>6W</b>	Initial Lumens	657	955	955	955	955	955
	Delivered Lumens	586	718	755	754	726	602
	UGR		13.5	13	16.4	19.1	21
<b>9W</b>	Initial Lumens	890	1296	1296	1296	1296	1296
	Delivered Lumens	794	978	1034	1038	984	825
	UGR		14.6	14.3	17.7	19.6	22.3
<b>12W</b>	Initial Lumens	1122	1618	1618	1618	1618	1618
	Delivered Lumens	999	1225	1314	1319	1238	1051
	UGR		15.2	15.1	18.3	21.2	22.9
<b>15W</b>	Initial Lumens	1267	2015	2015	2015	2015	2015
	Delivered Lumens	1060	1470	1628	1642	1565	1227
	UGR		15.9	15.8	19	21.9	23.6
<b>20W</b>	Initial Lumens	1485	2422	2422	2422	2422	2422
	Delivered Lumens	1244	1778	1967	1985	1895	1482
	UGR		16.6	16.4	19.7	22.5	24.3
<b>24W</b>	Initial Lumens		2799	2799	2799	2799	2799
	Delivered Lumens		2107	2273	2296	2193	1713
	UGR		17.4	17	20.2	23.1	24.8
<b>28W</b>	Initial Lumens		3128	3128	3128	3128	3128
	Delivered Lumens		2343	2542	2569	2458	1914
	UGR		17.7	17.3	20.6	23.6	25.2
<b>32W</b>	Initial Lumens		3405	3405	3405	3405	3405
	Delivered Lumens		2544	2768	2785	2679	2080
	UGR		18	17.7	20.9	23.9	25.4

\* Values are listed at 3000K, 90+ CRI with a white bevel & trim.

Notes

1. 12° spread without lens on trim

## COLOR TEMPERATURE MULTIPLIER FOR DELIVERED LUMENS

2700K	3000K	3500K	4000K
0.95	1.00	1.04	1.07

3" ARCHITECTURAL SQUARE DOWNLIGHT COMPATIBLE WITH ARMSTRONG® WOODWORKS®  
 LINEAR SOLID WOOD PANELS 3¼" WIDE PLANKS

## HOUSING DIMENSIONS 6W-20W

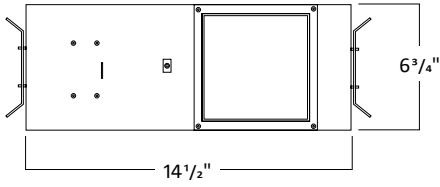

WW8176 - Woodwork No. 8176

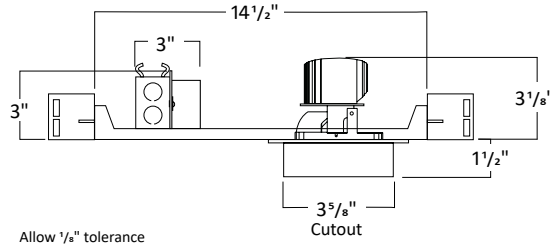

Allow 1/8" tolerance

## HOUSING DIMENSIONS 24W-32W

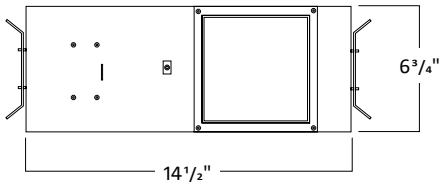

WW8176 - Woodwork No. 8176

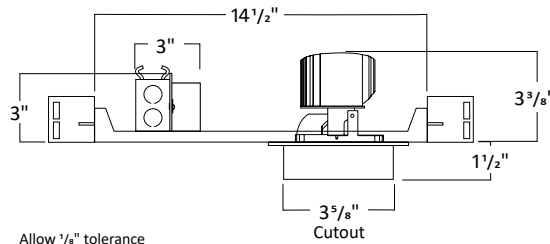

Allow 1/8" tolerance

## FRAME ACCESSORIES

### UNIVERSAL BAR HANGER

#### COMPATIBLE CEILING

- Hat Channel
- T-Bar
- C-Channel
- Laminated Wood
- Quick-Span
- I-Beam
- Standard Joist

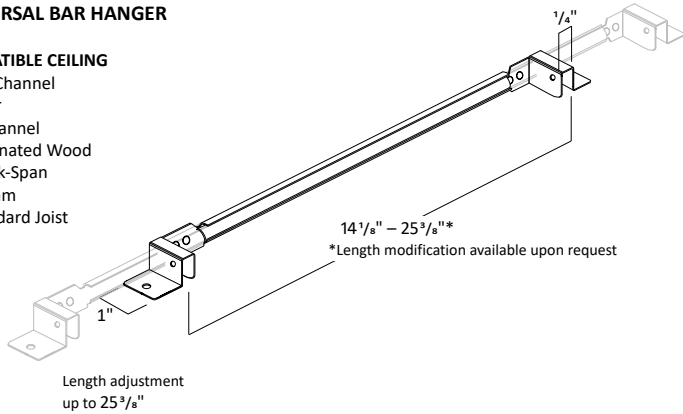

## LED MODULE

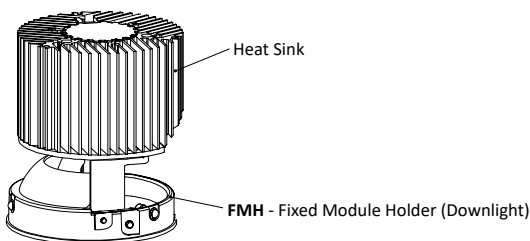

3" ARCHITECTURAL SQUARE DOWNLIGHT COMPATIBLE WITH ARMSTRONG® WOODWORKS®  
 LINEAR SOLID WOOD PANELS 3¼" WIDE PLANKS

## FILTERS

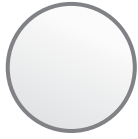

Frosted Filter



Honey Comb

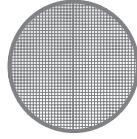

Solite Filter



Linear Filter

## TRIM DIMENSIONS

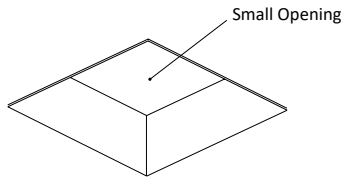

3SLO-CS

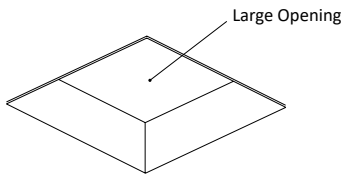
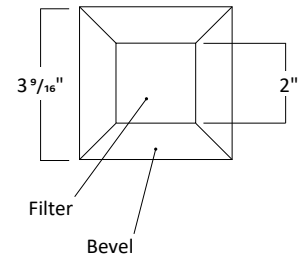
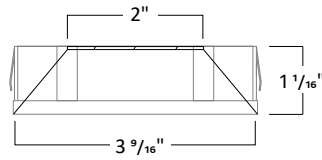

3SLO-CL

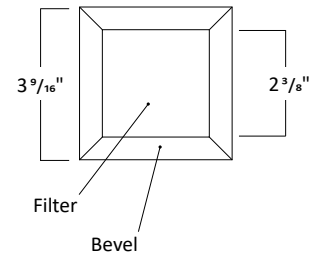
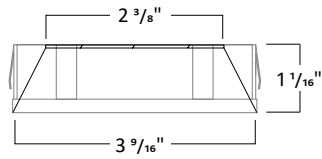

## TRIM FINISH



White



Black



Haze



Bronze



Clear

\*Consult Factory for Made to Order Finishes