

USE OF PRODUCT

The 3" PRIME Wall Wash with Warm-Dim is a small aperture fixture with shallow height that may be used in residential and commercial applications. Available in die cast trims, with an assortment of optics and dimmable drivers. Color Temperature gradually transitions from 3000K to 1800K simulating natural sunsets.

LED ENGINE

LED engine available with Warm-Dim standard 90+ CRI. 2 Step MacAdam ellipse allows for color consistency between fixtures. LED mounted to aluminum heat sink for maximum life output and thermal management. Light engine provides a quick disconnect with locking strain relief to housing.

FRAME CONSTRUCTION

IC rated housing constructed from 16 gauge heavy duty powder coated cold rolled steel frame. Junction box with 1/2" knock-outs. Butterfly bracket included to accommodate adjustable bar hangers or C-channel (ordered separately).

ADJUSTMENT

- Light engine locked at 25° tilt, consult factory for other tilt setting.
- Housing provides for 359° locking rotation

- Aperture collar adjusts 15°± horizontally within frame for square ceiling alignment.
- Collar notch allows for easy alignment for square applications.
- Aperture collar compatible up to 1½" ceiling thickness.
- Consult factory for made to order aperture collars exceeding 1½".

OPTICAL LENS & FILTERS (Field Replaceable)

Field replaceable optical lens available in 12°, 22°, 27°, 35° and 45°. Easily achieve narrow spot to wide flood beam pattern.

DIMMING

Available in 7 driver selections. (ID) Standard all-inclusive ELV(120V), Triac(120V), and 0-10V(120-277V) dimming driver called Intelligent Drive, 120-277V. (PEQ0) Lutron Hi-Lume Premier Ecosystem 0.1% w/soft on, fade to black dimming, 120-277V. (LDE1) Lutron Hi-Lume 1% Ecosystem with soft on, fade to black dimming, 120-277V. (LDE5) Lutron Hi-Lume 5% Ecosystem, 120-277V. (L3DA) Hi-lume 1% EcoSystem/3-Wire L3D Driver (EEI) eldoLED Eco 1% Dim (0-10V), 120-277V. (EDIO) eldoLED Solo 0.1% Dim(0-10V), 120-277V. (EDID) eldoLED Solo 0.1% Dim(DALI), 120-277V. Driver accessible from below ceiling.

THERMAL MANAGEMENT

Ambient temperatures at fixture location should not exceed -20° to 40°C.

EMERGENCY BATTERY

Optional emergency battery available for a minimum of 90 minutes with remote test switch in 800 delivered lumens.

TRIM

Trim available in die cast or spun aluminum. Consult factory for made to order finishes. Flanged trim is compatible with all ceiling materials.

LABELS/COMPLIANCE/WARRANTY

- CSA Listed for US and Canada
- Dry/Damp/Wet location rated.
- Energy Star
- Title 24, JA8 Compliant
- 5 Year limited warranty



ORDERING INFORMATION

RPM

Series	Aperture Size	Lumens	Color Temperature	Voltage	Dimming	Optical Lens	Filter
RPA	3 - 3"	9L - 975 lm	WD - Warm Dim	UNV - 120-277	ID ¹ - Standard all-inclusive ELV, Triac, and 0-10V dimming driver (Intelligent Drive)	12 - 12° 22 - 22° 27 - 27° 35 - 35° 45 - 45°	None - Leave blank F - Frosted filter H - Honey comb S - Solite filter L - Linear filter
PRIME Series		11L - 1100 lm		120 - 120V 347 - 347V	PEQ0- Lutron Hi-Lume Premier Ecosystem 0.1% w/ soft on, fade to black dimming LDE1 ² - Lutron Hi-Lume 1% Ecosystem with soft on, fade to black dimming L3DA- Hi-lume 1% EcoSystem/3-Wire L3D Driver EEI ² - eldoLED Eco 1% Dim (0-10V) EDIO ^{2,3} - eldoLED Solo 0.1% Dim (0-10V) EDID ^{2,3} - eldoLED Solo 0.1% Dim (DALI)		

Housing Type	Aperture	Frame Accessories	Collar	Options
IC - Air-tight New Construction	SFW - Square Flanged Wall Wash	UH ⁴ - Universal bar hanger C - C-Channel bar hanger B - Flat bar hanger	Blank - 1.0" Depth 15 - 1.5" Depth 20 - 2.0" Depth 30 - 3.0" Depth MTO - Made to order	ER8 ² - Emergency battery with remote switch (800 Lumens) CP ⁴ - Chicago Plenum

TRIM ORDERING INFORMATION

Aperture Size / Shape / Trim Type / Style	Bevel Opening	Bevel	Flange	Options
3SFA - 3" Square Flange Accent	Die Cast CL - Die cast large opening	W - White B - Black BZ - Bronze C - Clear MTO - Made to order	W - White B - Black BZ - Bronze MTO - Made to order	WL - Wet Location
	Spun Aluminum (Self Flanged) AL - Spun alum. large opening	W - White H - Haze C - Clear MTO - Made to order		WL - Wet Location

- Notes
1. Intelligent Drive is the standard driver.
 2. Ceiling access required.
 3. Must specify logarithmic or inear eldoLED diver.
 4. Requires IC Housing

LUMEN CHART

Wattage	Delivered Lumens	Voltage	CRI
10W	975 lm	120 - 277V	93+
12W	1100 lm	120 - 277V	93+

TRIM THICKNESS

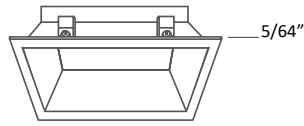

Die Cast

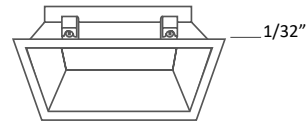

Spun Aluminum

TRIM DIMENSION

Accent Opening

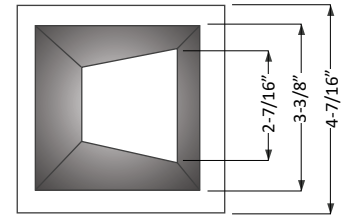
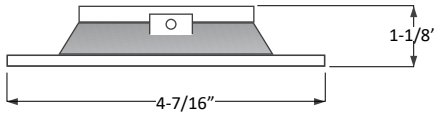

MODULE/HEATSINK, LED HOLDER & FILTER DIMENSION

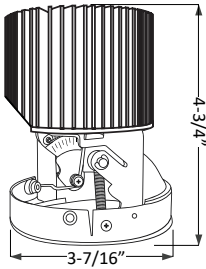

Module & Heatsink

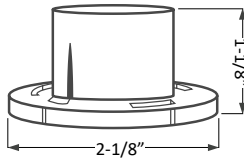

LED Holder (Body)

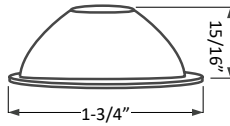

Optics

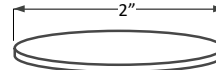

Filter

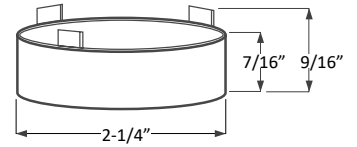

LED Holder (Head)

HOUSING DIMENSION

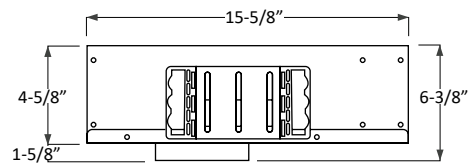
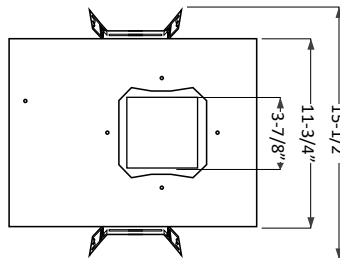
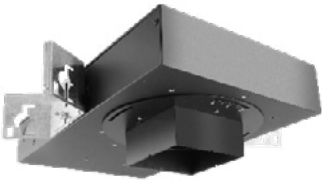

COLLAR DEPTH PER CEILING THICKNESS

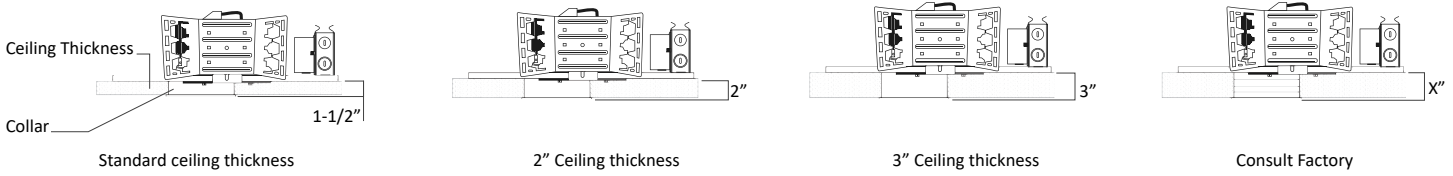

FRAME ACCESSORIES

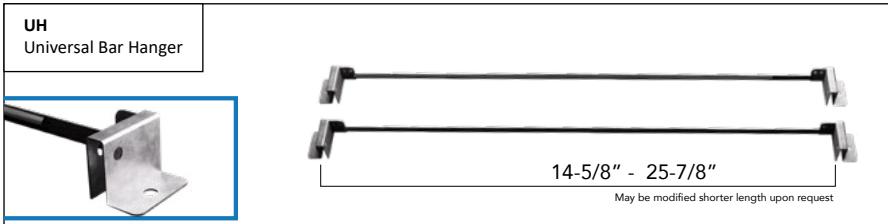
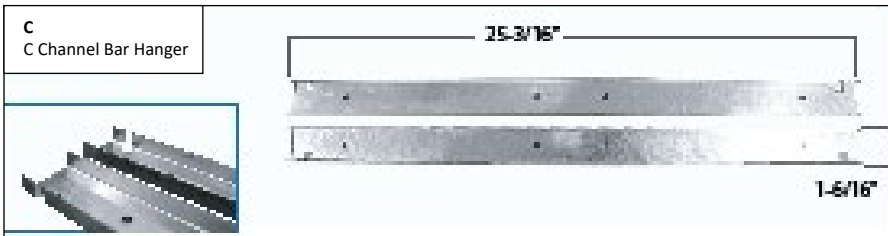
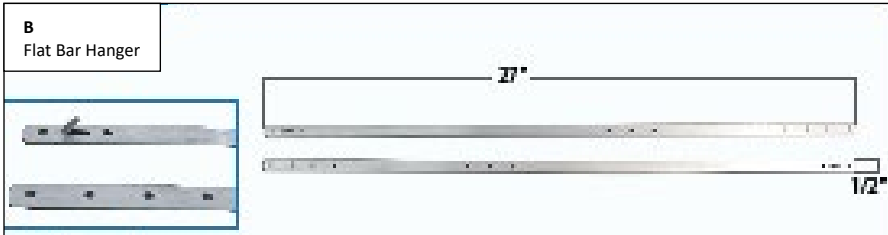

UNIVERSAL BAR HANGER

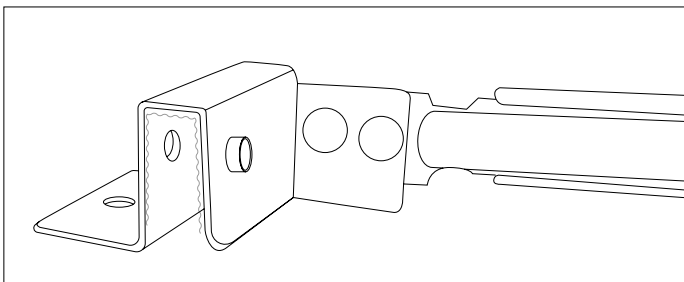

- Compatible Ceiling
- Hat Channel
 - T-Bar
 - C Channel
 - Laminated Wood
 - Quick-Span
 - I-Beam
 - Standard Joist