

WARM-DIM

USE OF PRODUCT

The 3" PRIME Wall Wash is a small aperture fixture with shallow height that may be used in residential and commercial applications. Die cast trims with an assortment of color temperatures, optics and dimmable drivers. May be used in plaster, wood and marble ceilings.

PRIME FEATURES

Color Temperature: Warm Dim (3000K-1800K)
SDCM: 2 step binning
Color Rendering Index: 93+ CRI
Optical Lens: 12°, 22°, 27°, 35°, 45°
Trim: Die cast
LED Life: 50,000 Hours
LED Type: Cree LED
Driver Info: 120-277V, 50/60 Hz, PF>0.9, THD<0.20
Warranty: 5 year limited warranty

LED ENGINE

LED engine available with Warm-Dim standard 90+ CRI. 2 Step MacAdam ellipse allows for color consistency between fixtures. LED mounted to aluminum heat sink for maximum life output and thermal management. Light engine provides a quick disconnect with locking strain relief to housing.

FRAME CONSTRUCTION

Constructed from 16 gauge heavy duty powder coated cold rolled steel frame with a large access junction box.

ADJUSTMENT

- Light engine locked at 25° tilt, consult factory for other tilt setting.
- Housing provides for 360° locking rotation
- Aperture collar compatible up to 1½" ceiling thickness.
- Accommodation for 2" or 3" ceiling thickness available upon request.

OPTICAL LENS (Field Replaceable)

Field replaceable optical lens available in 12°, 22°, 27°, 35° and 45°. Easily achieve narrow spot to wide flood beam pattern.

DIMMING

Available in 7 driver selections. (ID) Standard all-inclusive ELV(120V), Triac(120V), and 0-10V(120-277V) dimming driver called Intelligent Drive, 120-277V. (PEQ0) Lutron Hi-Lume Premier Ecosystem 0.1% w/soft on, fade to black dimming, 120-277V. (LDE1) Lutron Hi-Lume 1% Ecosystem with soft on, fade to black dimming, 120-277V. (LDE5)

Lutron Hi-Lume 5% Ecosystem, 120-277V. (L3DA) Hi-lume 1% EcoSystem/3-Wire L3D Driver (EEI) eldoLED Eco 1% Dim (0-10V), 120-277V. (EDIO) eldoLED Solo 0.1% Dim(0-10V), 120-277V. (EDID) eldoLED Solo 0.1% Dim(DALI), 120-277V. Driver accessible from below ceiling.

THERMAL MANAGEMENT

Ambient temperatures at fixture location should not exceed -20° to 40°C.

EMERGENCY BATTERY

Optional emergency battery available for a minimum of 90 minutes with remote test switch in 800 delivered lumens.

TRIM

Die cast trim. Consult factory for made to order finishes.

LABELS/COMPLIANCE/WARRANTY

- CSA Listed for US and Canada
- Dry/Damp/Wet location rated.
- Energy Star
- Title 24, JA8 Compliant
- 5 Year limited warranty



ORDERING INFORMATION

RPM Family Mounting types Module Configuration Module Size/Lumens Color Temperature Optical Lens Voltage Dimming Optical Lens Filter Trim Type Frame Finish

Series	Aperture Size	Lumens	Color Temperature	Voltage	Dimming	Optical Lens	Filter
RPA	3 - 3"	9L - 975 lm	WD - Warm Dim	UNV - 120-277	ID ¹ - Standard all-inclusive ELV, Triac, and 0-10V dimming driver (Intelligent Drive)	12 - 12°	None - Leave blank
PRIME Series		11L - 1100 lm		120 - 120V	PEQ0- Lutron Hi-Lume Premier Ecosystem 0.1% w/ soft on, fade to black dimming	22 - 22°	F - Frosted filter
				347 - 347V	LDE1 ² - Lutron Hi-Lume 1% Ecosystem with soft on, fade to black dimming	27 - 27°	H - Honey comb
					L3DA- Hi-lume 1% EcoSystem/3-Wire L3D Driver	35 - 35°	S - Solite filter
					EEI ² - eldoLED Eco 1% Dim (0-10V)	45 - 45°	L - Linear filter
					EDIO ^{2,3} - eldoLED Solo 0.1% Dim (0-10V)		
					EDID ^{2,3} - eldoLED Solo 0.1% Dim (DALI)		

Housing Type	Aperture	Frame Accessories	Collar	Options
IC - Air-tight New Construction	RLWP - Round Flangeless Wall Wash Plaster RLWM - Round Flangeless Wall Wash Millwork	UH ⁴ - Universal bar hanger C - C-Channel bar hanger B - Flat bar hanger	Blank - 1.0" Depth 15 - 1.5" Depth 20 - 2.0" Depth 30 - 3.0" Depth MTO - Made to order	ERB ² - Emergency battery with remote switch (800 Lumens) CP ⁴ - Chicago Plenum

TRIM ORDERING INFORMATION

Aperture Size / Shape / Trim Type / Style	Bevel Opening	Bevel	Options
3RLA - 3" Round Flangeless Accent	CL - Die cast large opening	W - White B - Black BZ - Bronze C - Clear MTO - Made to order	WL - Wet Location

Notes
1. Intelligent Drive is the standard driver.
2. Ceiling access required.
3. Must specify logarithmic or inear eldoLED diver.
4. Requires IC Housing

LUMEN CHART

Wattage	Delivered Lumens	Voltage	CRI
10W	975 lm	120 - 277V	93+
12W	1100 lm	120 - 277V	93+

TRIM DIMENSION

Accent Trim

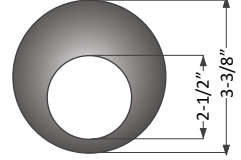
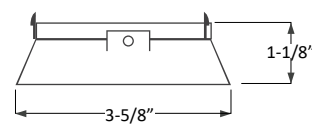

MODULE/HEATSINK, LED HOLDER & FILTER DIMENSION

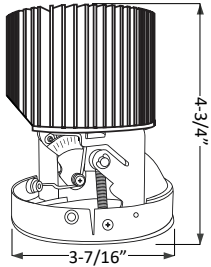

Module & Heatsink

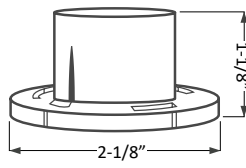

LED Holder (Body)

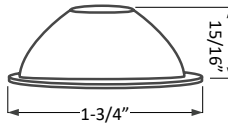

Optics

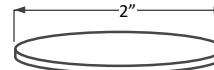

Filter

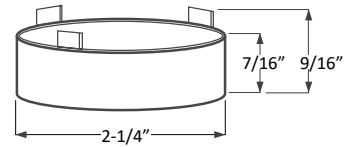

LED Holder (Head)

HOUSING DIMENSION

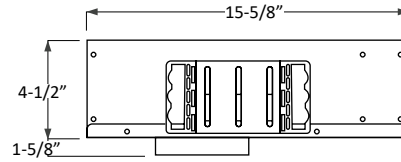
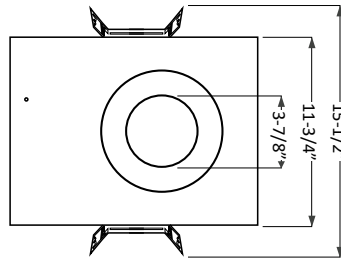

COLLAR DEPTH PER CEILING THICKNESS

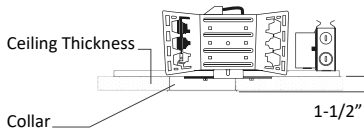

Standard ceiling thickness

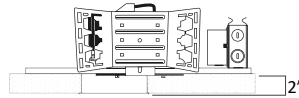

2" Ceiling thickness

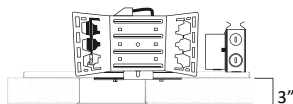

3" Ceiling thickness

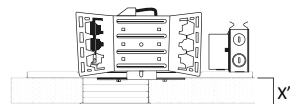

Consult Factory

FRAME ACCESSORIES

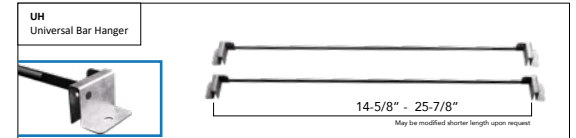
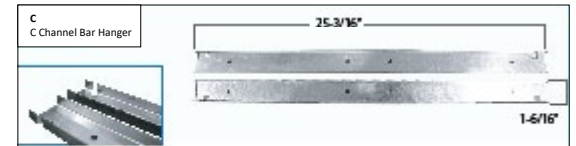
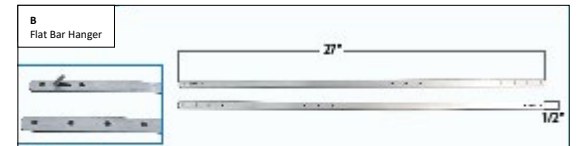

UNIVERSAL BAR HANGER

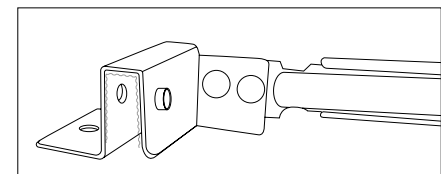

Compatible Ceiling
- Hat Channel
- T-Bar
- C Channel
- Laminated Wood
- Quick-Span
- I-Beam
- Standard Joist