

PRIME 6" LED ARCHITECTURAL SQUARE LUMINAIRE

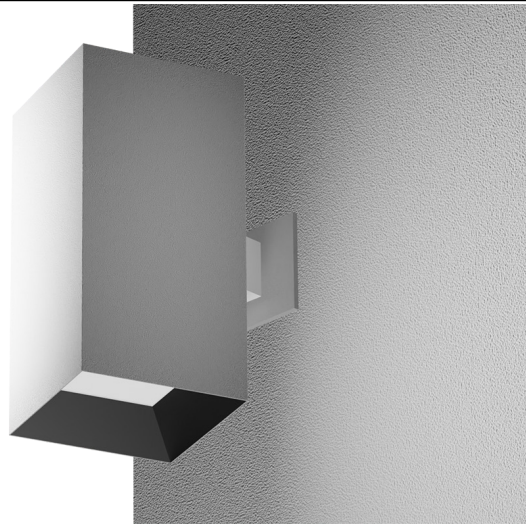

USE OF PRODUCT

PRIME Square Luminaire Series may be used in hospitality, commercial, retail, and residential applications. This product will reduce energy consumption, emits little heat, and reduces cooling loads for added costs savings. Approximately 75% in energy savings compared to incandescent light source. This product is for indoor use only.

LED ENGINE

LED engine available with CREE LEDs in 2700K, 3000K, 3500K, or 4000K in standard 93+ CRI. 2 Step MacAdam ellipse allows for color consistency between fixtures. LED mounted to aluminum heat sink for maximum life output and thermal management.

LED DRIVER

Durable dimmable driver provides high power factor with optimum thermal management to prevent damage caused by high temperature.

OPTICS

Field replaceable optical lens available in 18°, 30°, 50°, and 80°. Easily achieve narrow spot to wide flood beam pattern. Option for frosted, honeycomb, or solite filter (2 Maximum).

HOUSING

Rugged aluminum housing.

MOUNTING

The PRIME Cylinder Series may be cable hung, stem mount, surface mount or wall mounted.

DIMMING

Available in 8 driver selections. (ID) Standard all-inclusive ELV, Triac, and 0-10V dimming driver called Intelligent Drive, 120-277V. (PEQ0) Lutron Hi-Lume Premier Ecosystem 0.1% w/soft on, fade to black dimming, 120-277V. (PEQ1) Lutron Hi-Lume Premier Ecosystem 1% w/soft on, fade to black

dimming, (LDE1) Lutron Hi-Lume 1% Ecosystem with soft on, fade to black dimming, 120-277V. (L3DA) Hi-lume 1% EcoSystem/3-Wire L3D Driver (EEI) eldoLED Eco 1% Dim (0-10V), 120-277V. (EDIO) eldoLED Solo 0.1% Dim(0-10V), 120-277V. (EDID) eldoLED Solo 0.1% Dim(DALI), 120-277V.

LABELS / COMPLIANCE

- CSA Listed for US and Canada
- Damp rated
- 5 year limited warranty.



ORDERING INFORMATION

RPA

Diameter Shape Length Directional Lumens Color Temp. Voltage Dimming Optical Lens Filter Bevel Finish Cylinder Finish Mounting Option

Series	Diameter	Shape	Length	Directional	Lumens	Color Temperature	Voltage	Dimming
RPA PRIME Series	6 - 6"	SL - Square Luminaire	12 - 12"	DL - Down Light	10L - 1045 lm	27 - 2700K	UNV - 120-277	ID ¹ Standard all-inclusive ELV, Triac, and 0-10V dimming driver (Intelligent Drive)
				UP - Up Light	13L - 1345 lm	30 - 3000K		PEQ0 Lutron Hi-Lume Premier Ecosystem 0.1% w/soft on, fade to black dimming
					16L - 1645 lm	35 - 3500K		LDE1 Lutron Hi-Lume 1% Ecosystem with soft on, fade to black dimming
					21L - 2145 lm	40 - 4000K		LDES Lutron Hi-Lume 5% Ecosystem
					25L - 2505 lm			L3DA Hi-lume 1% EcoSystem/3-Wire L3D Driver

Optical Lens ⁵	Filter	Bevel Finish	Cylinder Finish	Mounting	Option
18 - 18°	None - Leave blank	W - White	BL - Black	PH - Pendant	EM - Emergency Battery
30 - 30°	F - Frosted Filter	B - Black	WH - White	SC - Single Cable	EI4W - Integral Emergency Battery
50 - 50°	H - Honey comb	H - Haze	SL - Silver	DC - Double Cable	LAW - Lutron Athena Wireless Node (RF only version)
80 - 80°	S - Solite filter	S - Specular Clear	MTO - Made to order	TC - Triple Cable	
		W - Wheat		SM - Surface Mount	
		MTO - Made to order		WM - Wall Mount	

- Intelligent Drive is the standard driver.
- 120V only.
- Must specify logarithmic or linear eldoLED diver.
- Confirm dimming curve: linear or logarithmic.
- Without standard frosted acrylic diffuser
- .18" standard length, consult factory for other.
- .5ft standard cable length.

LUMEN CHART

Wattage	Delivered Lumens	Voltage	CRI
11W	1045 lm	120 - 277V	93+
16W	1345 lm	120 - 277V	93+
20W	1645 lm	120 - 277V	93+
30W	2145 lm	120 - 277V	93+
31W	2505 lm	120 - 277V	93+

*Above chart, ordering information, and IES File name reflect delivered lumens based 3000K and 30° optical lens.
 **Lumens will vary based on CCT, optical lens, and bevel finish.

WALL MOUNT DIMENSION

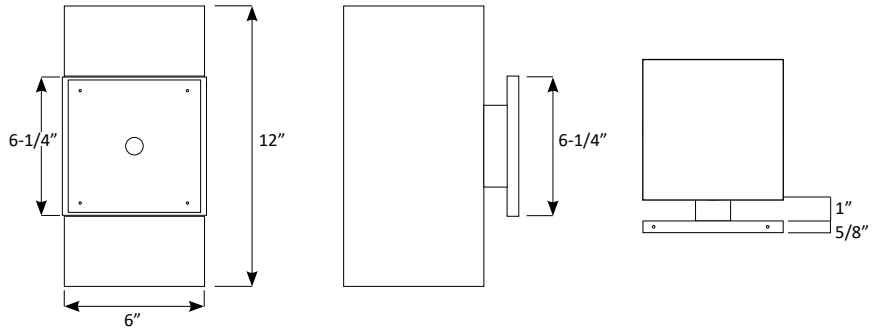

TRIM HEIGHT

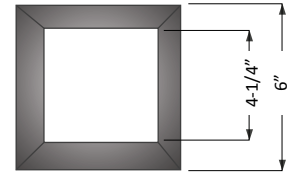
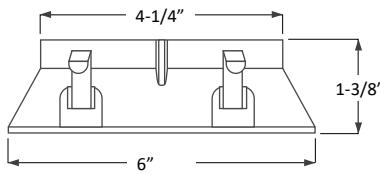
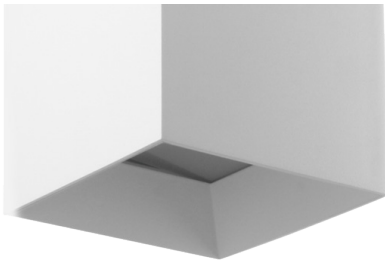

LED HOLDER & FILTER DIMENSION

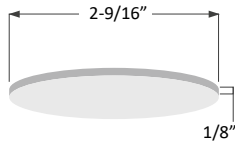

Filter

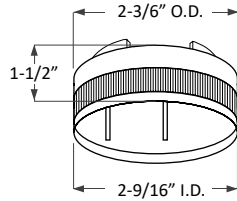

LED Holder

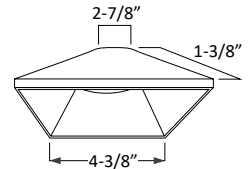
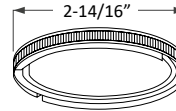

Light Enhancer

MOUNTING INFO

CABLE HUNG DIMENSION

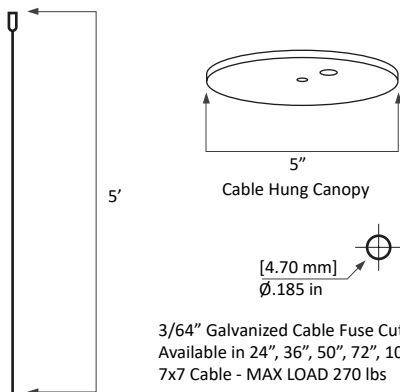

3/64" Galvanized Cable Fuse Cut with Die Cast #1 Stop
 Available in 24", 36", 50", 72", 100", 120", & 150" Lengths
 7x7 Cable - MAX LOAD 270 lbs

STEM MOUNT DIMENSION

